

**BENCHMARKS:**  
 Benchmark #1: Big arm of fire hydrant on North side of Valley Court across from #248 West Grand River Avenue (car wash).  
 Elevation: 846.85  
 Benchmark #2: Big arm of fire hydrant on North side of intersection of Evergreen Avenue and Albert Avenue.  
 Elevation: 853.44

- UTILITY NOTES**
- ALL WORKMANSHIP, MATERIALS, AND CONSTRUCTION PRACTICES SHALL CONFORM TO THE REQUIREMENTS OF THE CITY OF EAST LANSING OR THE AGENCY HAVING JURISDICTION OVER THE APPLICABLE UTILITY.
  - CONTRACTOR IS RESPONSIBLE FOR REPAIRS OF DAMAGE TO ANY EXISTING UTILITY DURING CONSTRUCTION AT NO COST TO THE OWNER.
  - ALL FILL MATERIAL IS TO BE IN PLACE, AND COMPACTED BEFORE INSTALLATION OF PROPOSED UTILITIES.
  - CONTRACTOR SHALL NOTIFY THE UTILITY COMPANIES 72 HOURS BEFORE CONNECTING TO ANY EXISTING LINE.
  - IN THE EVENT OF A VERTICAL CONFLICT BETWEEN WATERLINES, SANITARY LINES, STORM LINES AND GAS LINES (EXISTING AND PROPOSED), THE CONTRACTOR SHALL NOTIFY THE ENGINEER AS SOON AS THE CONFLICT IS DISCOVERED.
  - TOPS OF EXISTING UTILITY STRUCTURES SHALL BE ADJUSTED TO FINISHED GRADE.
  - DRAWINGS DO NOT ATTEMPT TO SHOW ALL EXISTING UTILITIES.
  - EXISTING UTILITIES SHALL BE VERIFIED IN FIELD PRIOR TO INSTALLATION OF ANY NEW LINES.
  - CONTRACTOR IS RESPONSIBLE FOR COMPLYING TO THE CONSTRUCTION REQUIREMENTS OF THE UTILITY OWNERS.
  - THE CONTRACTOR IS SPECIFICALLY CAUTIONED THAT THE LOCATION AND/OR ELEVATION OF EXISTING UTILITIES AS SHOWN ON THESE PLANS IS BASED ON RECORDS OF THE VARIOUS UTILITY COMPANIES, AND WHERE POSSIBLE MEASUREMENTS TAKEN IN THE FIELD. THE INFORMATION IS NOT TO BE RELIED ON AS BEING EXACT OR COMPLETE. THE CONTRACTOR MUST CALL THE APPROPRIATE UTILITY COMPANIES AT LEAST 72 HOURS BEFORE ANY EXCAVATION TO REQUEST EXACT FIELD LOCATION OF UTILITIES. IT SHALL BE THE RESPONSIBILITY OF THE CONTRACTOR TO RELOCATE ALL EXISTING UTILITIES WHICH CONFLICT WITH THE PROPOSED IMPROVEMENTS SHOWN ON THE PLANS.
  - CONTRACTOR SHALL COORDINATE WITH ALL UTILITY COMPANIES FOR INSTALLATION REQUIREMENTS AND SPECIFICATIONS.
  - CONTRACTOR SHALL REFER TO ARCHITECTURAL PLANS AND SPECIFICATIONS FOR ACTUAL LOCATION AND ELEVATIONS OF ALL UTILITY ENTRANCES TO INCLUDE SANITARY SEWER LATERALS, DOMESTIC AND FIRE PROTECTION WATER SERVICE, ELECTRICAL, TELEPHONE, AND GAS SERVICE. CONTRACTOR SHALL COORDINATE INSTALLATION OF UTILITIES, IN SUCH A MANNER AS TO AVOID CONFLICTS AND ASSURE PROPER DEPTHS ARE ACHIEVED AS WELL AS COORDINATING WITH CITY UTILITY REQUIREMENTS AS TO LOCATION AND SCHEDULING FOR TIE-INS/CONNECTIONS PRIOR TO CONNECTING TO EXISTING UTILITIES.
  - THE CONTRACTOR SHALL CONDUCT ALL REQUIRED TESTS TO THE SATISFACTION OF THE RESPECTIVE UTILITY COMPANIES AND THE OWNER'S INSPECTING AUTHORITIES.
  - CONTRACTOR SHALL COMPLY TO THE FULLEST EXTENT WITH THE LATEST STANDARDS OF OSHA DIRECTIVES OR ANY OTHER AGENCY HAVING JURISDICTION FOR EXCAVATION AND TRENCHING PROCEDURES. THE CONTRACTOR SHALL USE SUPPORT SYSTEMS, SLOPING, BENCHING, AND OTHER MEANS OF PROTECTION. THIS TO INCLUDE BUT NOT LIMITED TO ACCESS AND EGRESS FROM ALL EXCAVATION AND TRENCHING. CONTRACTOR IS RESPONSIBLE TO COMPLY WITH PERFORMANCE CRITERIA FOR OSHA.
  - CONTRACTOR SHALL FIELD VERIFY ALL EXISTING PIPE SIZES AND INVERTS ELEVATIONS BEFORE ORDERING MANHOLE AND CATCH BASIN STRUCTURES.
  - ALL WORK WITHIN THE RIGHTS-OF-WAY SHALL CONFORM TO THE REQUIREMENTS OF THE CITY OF EAST LANSING AND THE MICHIGAN DEPARTMENT OF TRANSPORTATION.
  - A MINIMUM HORIZONTAL SEPARATION OF 10 FEET SHALL BE PROVIDED BETWEEN THE PROPOSED WATER MAIN AND ANY EXISTING OR PROPOSED SEWER MAIN. A MINIMUM VERTICAL SEPARATION OF 18 INCHES SHALL BE PROVIDED BETWEEN A PROPOSED WATER MAIN WHENEVER IT CROSSES A SEWER MAIN.

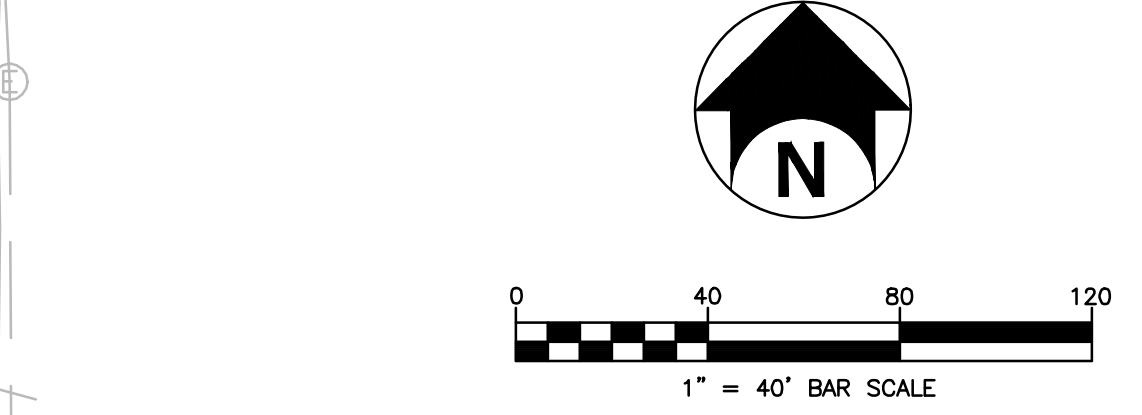
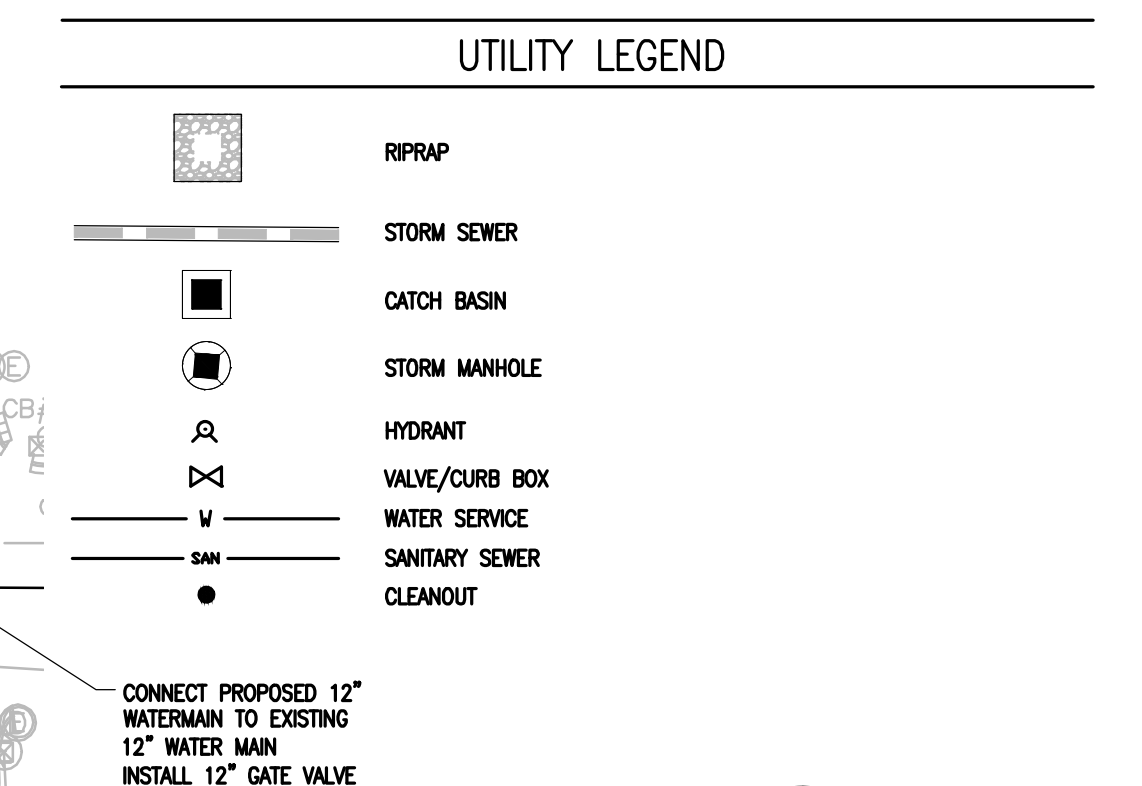

**NOT APPROVED:**  
 THIS PLAN HAS NOT RECEIVED FINAL APPROVAL OF ALL REVIEWING AGENCIES. THIS PLAN IS SUBJECT TO REVISIONS UNTIL ALL APPROVALS ARE OBTAINED AND SHOULD NOT BE USED FOR CONSTRUCTION PURPOSES.

# Park District

EAST LANSING, MI 48823



2502 Lake Lansing Rd.  
 Ste C, Lansing,  
 MI 48912



1427 West Saginaw Street, Suite 200  
 East Lansing, Michigan 48823

office: 517.272.9835  
 fax: 517.272.9836

www.bergmannpc.com

REVISIONS			
NO.	DATE	DESCRIPTION	REV. CK'D
06/30/14		SPR SUBMITTAL	
09/26/14		REVISED SPR SUBMITTAL	

## PRELIMINARY UTILITY PLAN

Project Manager:  
**T. AREND**  
 Designed by:  
**P. FURTAW / A. NODARSE**  
 Drawn by:  
**A. NODARSE**  
 Checked by:  
**P. FURTAW**  
 Date Issued:  
 February 28, 2014  
 Scale:  
**1" = 40'**

Date: \_\_\_\_\_  
 File Name: **C110DTH.DWG**  
 Project Number: **9843.00**  
 Drawing Number: \_\_\_\_\_

# C110

© DTM Management/CONSULTING LTD. PARK DISTRICT PRELIMINARY DESIGN/CD DESIGN/CD CHIL. C110DTH.DWG. ALVARADO/ADAM, JIMMIE. Friday, September 26, 2014 2:27:14 PM. USER: J. DUBOIS (4.00M BUCKLES) 1:11