

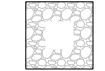





BENCHMARKS:

Benchmark #1: Big arm of fire hydrant on North side of Valley Court across from #248 West Grand River Avenue (car wash).
Elevation: 846.65
Benchmark #2: Big arm of fire hydrant on North side of intersection of Evergreen Avenue and Albert Avenue.
Elevation: 853.44

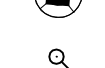
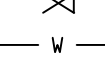
UTILITY LEGEND

-  RIPRAP
-  STORM SEWER
-  CATCH BASIN
-  STORM MANHOLE
-  HYDRANT
-  VALVE/CURB BOX
-  WATER SERVICE
-  SANITARY SEWER
-  CLEANOUT

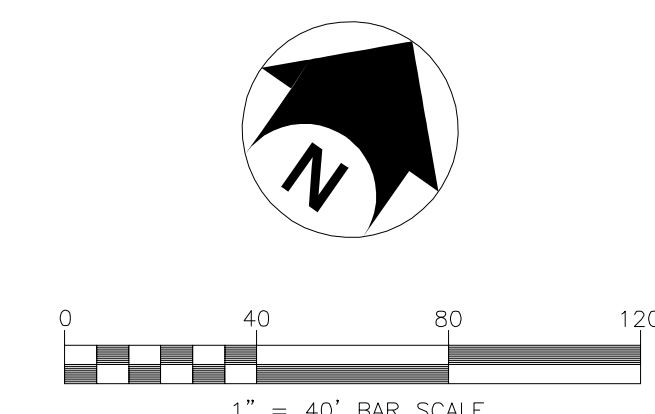
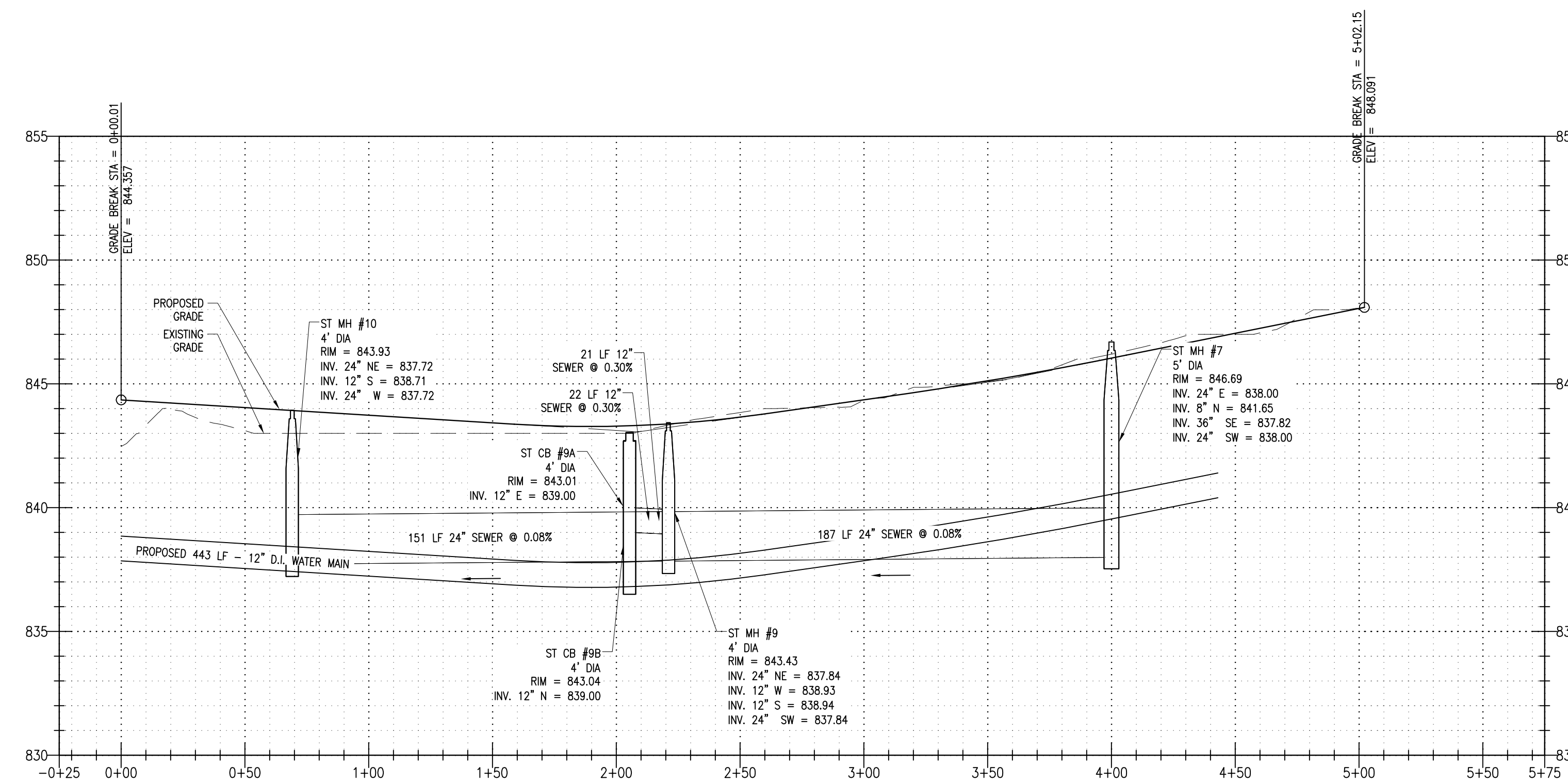
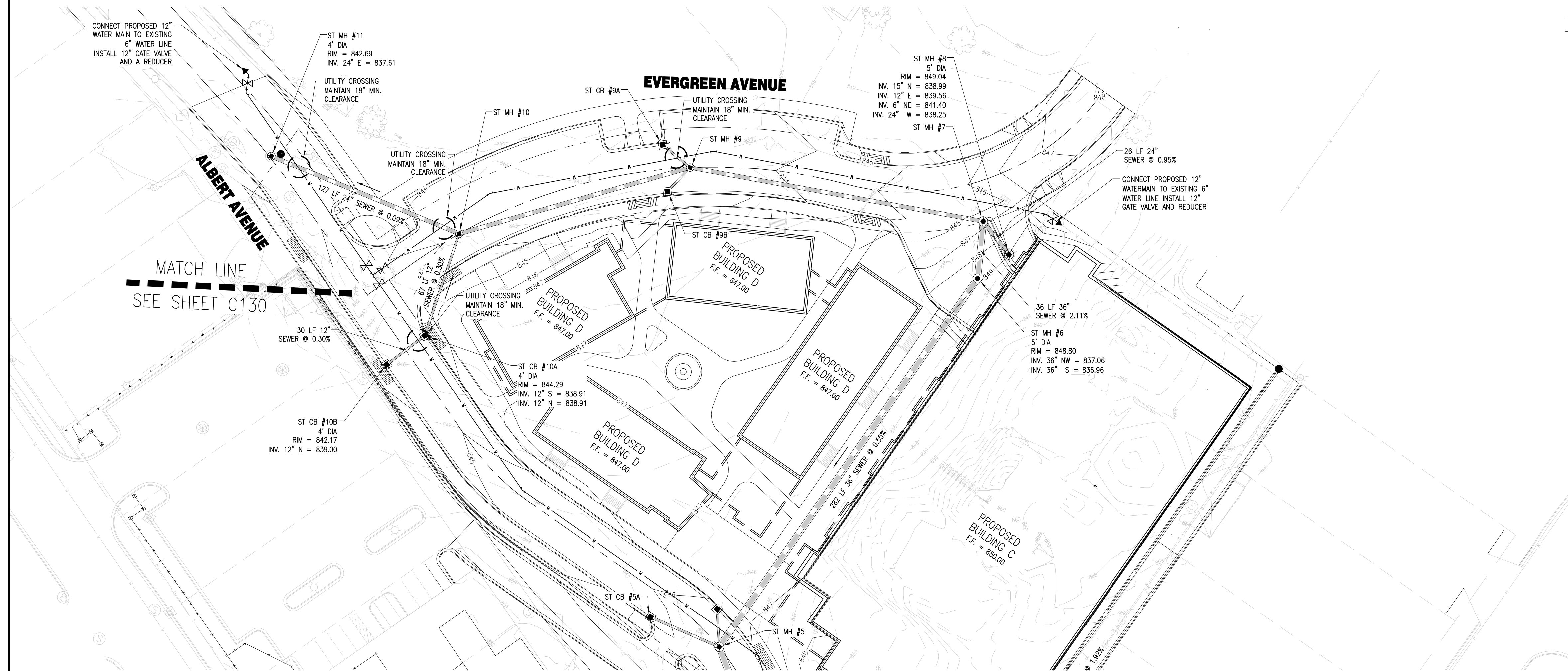

**Know what's below.
Call before you dig.**

NOT APPROVED:
THIS PLAN HAS NOT RECEIVED FINAL APPROVAL OF ALL REVIEWING AGENCIES. THIS PLAN IS SUBJECT TO REVISIONS UNTIL ALL APPROVALS ARE OBTAINED AND SHOULD NOT BE USED FOR CONSTRUCTION PURPOSES.

Park District

EAST LANSING, MI 48823



2502 Lake Lansing Rd.
Ste C, Lansing,
MI 48912

Bergmann
associates
architects // engineers // planners

1427 West Saginaw Street, Suite 200
East Lansing, Michigan 48823

office: 517.272.9835
fax: 517.272.9836

www.bergmannpc.com

REVISIONS

NO.	DATE	DESCRIPTION	REV.	CK'D

EVERGREEN AVENUE PLAN AND PROFILE

Project Manager:
T. ARENO
Designed by:
P. FURTAW / A. NODARSE
Drawn by:
A. NODARSE
Checked by:
P. FURTAW
Date Issued:
February 28, 2014
Scale:
1"=40' HORZ.; 1"=4' VERT.

Date: _____
Project Number: **9843.000** File Name: **C131.DWG**

Drawing Number:

C131

CIVIL ENGINEERING CONSULTANTS, INC. 10000 PARK DRIVE, SUITE 100, FARMINGTON HILLS, MI 48334
 PROJECT: EVERGREEN AVENUE, EAST LANSING, MI
 DATE: 02/28/14
 DRAWN BY: AN
 CHECKED BY: PF
 PROJECT NUMBER: 9843.000